

# REAR DOOR LATCH AND LOCK ACTUATOR INSPECTION

B3E091458490W05

1. The following actuator and switch are integrated with the rear door latch and lock actuator. Inspect the rear door latch and lock actuator according to each inspection procedure for the following items.

- Rear door lock actuator (See [REAR DOOR LOCK ACTUATOR INSPECTION.](#))
- Rear door latch switch (See [REAR DOOR LATCH SWITCH INSPECTION.](#))

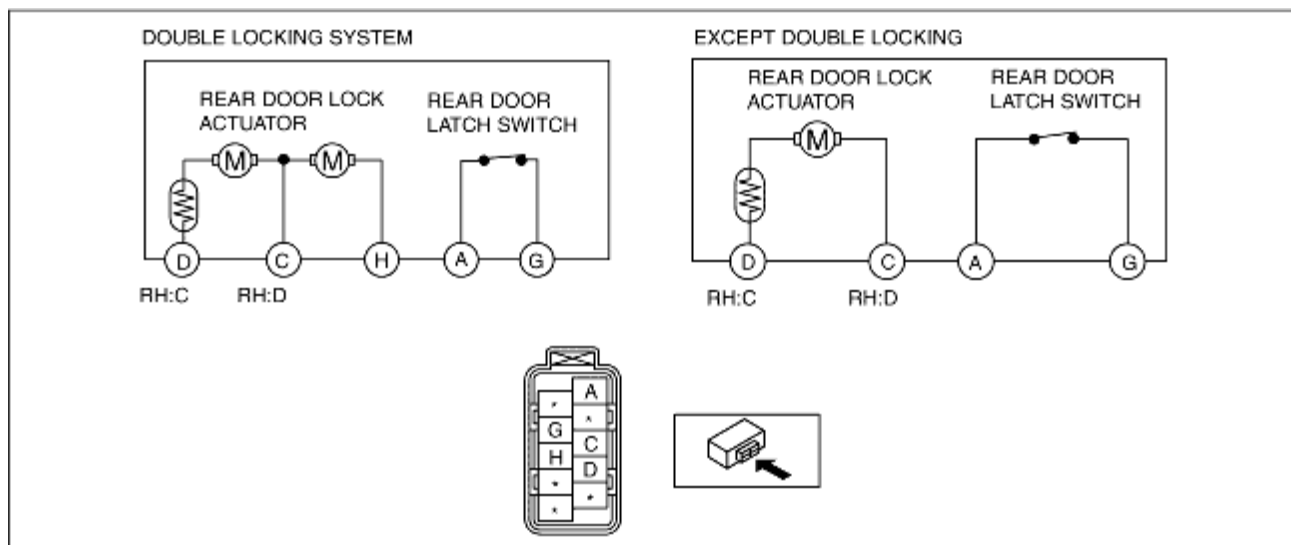

B3E0914W045